

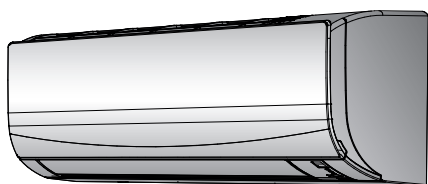

# Operation manual

## Daikin room air conditioner



FTXF20C5V1B  
FTXF25C5V1B  
FTXF35C5V1B  
FTXF42C5V1B

Operation manual  
Daikin room air conditioner

English

## Table of contents

<b>1</b>	<b>About the documentation</b>	<b>2</b>
1.1	About this document.....	2
<b>2</b>	<b>User safety instructions</b>	<b>2</b>
2.1	General.....	2
2.2	Instructions for safe operation.....	3
<b>3</b>	<b>About the system</b>	<b>4</b>
3.1	Indoor unit.....	4
3.2	About the user interface.....	5
3.2.1	Components: User interface.....	5
3.2.2	Status: User interface LCD.....	5
3.2.3	To operate the user interface.....	6
<b>4</b>	<b>Before operation</b>	<b>6</b>
4.1	To mount the user interface holder.....	6
4.2	To insert the batteries.....	6
4.3	To turn on the power supply.....	6
<b>5</b>	<b>Operation</b>	<b>6</b>
5.1	Operation range.....	6
5.2	When to use which feature.....	6
5.3	Operation mode and temperature setpoint.....	7
5.3.1	To start/stop operation mode and to set the temperature.....	7
5.3.2	Airflow rate.....	7
5.3.3	Airflow direction.....	8
5.3.4	Comfort airflow operation.....	8
5.3.5	Powerful operation.....	8
5.3.6	Econo operation.....	9
5.3.7	OFF/ON timer operation.....	9
<b>6</b>	<b>Energy saving and optimum operation</b>	<b>9</b>
<b>7</b>	<b>Maintenance and service</b>	<b>10</b>
7.1	Overview: Maintenance and service.....	10
7.2	To clean the indoor unit and user interface.....	10
7.3	To clean the front panel.....	11
7.4	About the air filters.....	11
7.5	To clean the air filters.....	11
7.6	To take following items into account before a long idle period..	11
<b>8</b>	<b>Troubleshooting</b>	<b>12</b>
8.1	Symptoms that are NOT system malfunctions.....	12
8.1.1	Symptom: A sound like water flowing is heard.....	12
8.1.2	Symptom: A blowing sound is heard.....	12
8.1.3	Symptom: A ticking sound is heard.....	12
8.1.4	Symptom: A whistling sound is heard.....	12
8.1.5	Symptom: A clicking sound during operation or idle time is heard.....	12
8.1.6	Symptom: A clapping sound is heard.....	12
8.1.7	Symptom: The outdoor fan rotates while the air conditioner is not in operation.....	12
8.2	Solving problems based on error codes.....	12
<b>9</b>	<b>Disposal</b>	<b>13</b>

## 1 About the documentation

### 1.1 About this document

Thank you for purchasing this product. Please:

- Read the documentation carefully before operating the user interface to ensure the best possible performance.

- Request the installer to inform you about the settings that he used to configure your system. Check if he has filled in the installer settings tables. If not, request him to do so.
- Keep the documentation for future reference.

#### Target audience

End users



#### INFORMATION

This appliance is intended to be used by expert or trained users in shops, in light industry, and on farms, or for commercial and household use by lay persons.

#### Documentation set

This document is part of a documentation set. The complete set consists of:

- **General safety precautions:**
  - Safety instructions that you must read before operating your system
  - Format: Paper (in the box of the indoor unit)
- **Operation manual:**
  - Quick guide for basic usage
  - Format: Paper (in the box of the indoor unit)
- **User reference guide:**
  - Detailed step-by-step instructions and background information for basic and advanced usage
  - Format: Digital files on <http://www.daikineurope.com/support-and-manuals/product-information/>

Latest revisions of the supplied documentation may be available on the regional Daikin website or via your installer.

The original documentation is written in English. All other languages are translations.

## 2 User safety instructions

Always observe the following safety instructions and regulations.

### 2.1 General



#### WARNING

If you are NOT sure how to operate the unit, contact your installer.



#### WARNING

Children aged from 8 years and above and persons with reduced physical, sensory or mental capabilities or lack of experience and knowledge can only use this appliance if they have been

given supervision or instruction concerning the use of the appliance by a person responsible for their safety.

Children **MUST NOT** play with the appliance.

Cleaning and user maintenance **MUST NOT** be carried out by children without supervision.

### **WARNING**

To prevent electrical shocks or fire:

- Do NOT rinse the unit.
- Do NOT operate the unit with wet hands.
- Do NOT place any objects containing water on the unit.

### **CAUTION**

- Do NOT place any objects or equipment on top of the unit.
- Do NOT sit, climb or stand on the unit.

- Units are marked with the following symbol:



This means that electrical and electronic products may NOT be mixed with unsorted household waste. Do NOT try to dismantle the system yourself: the dismantling of the system, treatment of the refrigerant, of oil and of other parts must be done by an authorized installer and must comply with applicable legislation.

Units must be treated at a specialized treatment facility for reuse, recycling and recovery. By ensuring this product is disposed of correctly, you will help to prevent potential negative consequences for the environment and human health. For more information, contact your installer or local authority.

- Batteries are marked with the following symbol:



This means that the batteries may NOT be mixed with unsorted household waste. If a chemical symbol is printed beneath the symbol, this chemical symbol means that the battery contains a heavy metal above a certain concentration.

Possible chemical symbols are: Pb: lead (>0.004%).

Waste batteries must be treated at a specialized treatment facility for reuse. By ensuring waste batteries are disposed of correctly, you will help to prevent potential negative consequences for the environment and human health.

## 2.2 Instructions for safe operation



### **WARNING: MILDLY FLAMMABLE MATERIAL**

The refrigerant inside this unit is mildly flammable.



### **CAUTION**

Do NOT insert fingers, rods or other objects into the air inlet or outlet. When the fan is rotating at high speed, it will cause injury.



### **WARNING**

- Do NOT modify, disassemble, remove, reinstall or repair the unit yourself as incorrect dismantling or installation may cause an electric shock or fire. Contact your dealer.
- In case of accidental refrigerant leaks, make sure there are no naked flames. The refrigerant itself is entirely safe, non-toxic and mildly flammable, but it will generate toxic gas when it accidentally leaks into a room where combustible air from fan heaters, gas cookers, etc. is present. Always have qualified service personnel confirm that the point of leakage has been repaired or corrected before resuming operation.



### **CAUTION**

ALWAYS use a user interface to adjust the position of the flaps and louvers. When the flaps and louvers are swinging and you move them forcibly by hand, the mechanism will break.



### **CAUTION**

NEVER expose little children, plants or animals directly to the airflow.



### **WARNING**

Do NOT place objects below the indoor and/or outdoor unit that may get wet. Otherwise condensation on the unit or refrigerant pipes, air filter dirt or drain blockage may cause dripping, and objects under the unit may get dirty or damaged.

### 3 About the system

#### **WARNING**

Do NOT place a flammable spray bottle near the air conditioner and do NOT use sprays near the unit. Doing so may result in a fire.

#### **WARNING**

The refrigerant inside the unit is mildly flammable, but normally does NOT leak. If the refrigerant leaks in the room and comes in contact with fire from a burner, a heater, or a cooker, this may result in fire, or the formation of a harmful gas.

Turn off any combustible heating devices, ventilate the room, and contact the dealer where you purchased the unit.

Do NOT use the unit until a service person confirms that the part from which the refrigerant leaked has been repaired.

#### **WARNING**

- Do NOT pierce or burn refrigerant cycle parts.
- Do NOT use cleaning materials or means to accelerate the defrosting process other than those recommended by the manufacturer.
- Be aware that the refrigerant inside the system is odourless.

#### **WARNING**

The appliance shall be stored in a room without continuously operating ignition sources (example: open flames, an operating gas appliance or an operating electric heater).

#### **DANGER: RISK OF ELECTROCUTION**

To clean the air conditioner or air filter, be sure to stop operation and turn all power supplies off. Otherwise, an electric shock and injury may result.

#### **CAUTION**

After a long use, check the unit stand and fitting for damage. If damaged, the unit may fall and result in injury.

#### **WARNING**

Be careful with ladders when working in high places.

#### **DANGER: RISK OF ELECTROCUTION**

Before cleaning, be sure to stop the operation, turn the breaker off or pull out the supply cord. Otherwise, an electric shock and injury may result.

#### **WARNING**

**Stop operation and shut off the power if anything unusual occurs (burning smells etc.).**

Leaving the unit running under such circumstances may cause breakage, electric shock or fire. Contact your dealer.

#### **CAUTION**

This unit is equipped with electrically powered safety measures, such as a refrigerant leak detector. In order to be effective, the unit must be electrically powered at all times after installation, except for short service periods.

## 3 About the system

#### **WARNING: MILDLY FLAMMABLE MATERIAL**

The refrigerant inside this unit is mildly flammable.

#### **NOTICE**

Do NOT use the system for other purposes. In order to avoid any quality deterioration, do NOT use the unit for cooling precision instruments, food, plants, animals, or works of art.

### 3.1 Indoor unit

#### **CAUTION**

Do NOT insert fingers, rods or other objects into the air inlet or outlet. When the fan is rotating at high speed, it will cause injury.

#### **INFORMATION**

The sound pressure level is less than 70 dBA.

#### **INFORMATION**

The following figures are just examples and may NOT completely match your system layout.

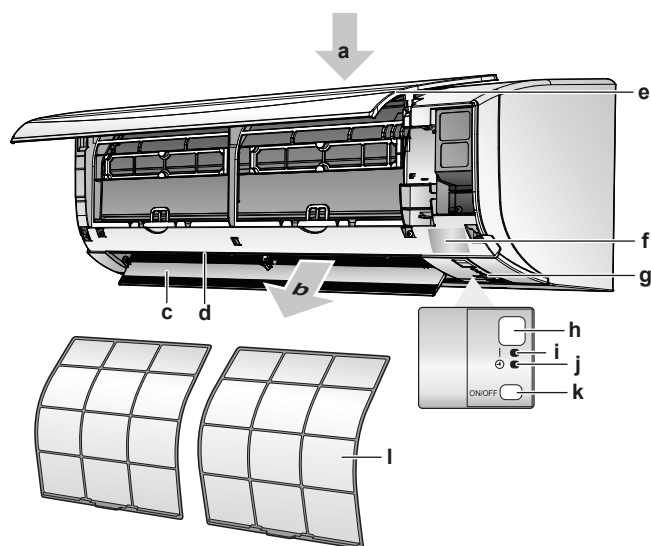

- a Air inlet
- b Air outlet
- c Flap (horizontal blade)
- d Louvers (vertical blades)
- e Front panel
- f Model name plate
- g Room temperature sensor
- h Signal receiver
- i Operation indicator (green)
- j Timer lamp (orange)
- k Indoor unit ON/OFF switch
- l Air filter

## ON/OFF button

If the user interface is missing, you can use the ON/OFF button on the indoor unit to start/stop operation. When operation is started using this button, the following settings are used:

- Operation mode = Automatic
- Temperature setting = 25°C
- Airflow rate = Automatic

## 3.2 About the user interface

- **Direct sunlight.** Do NOT expose the user interface to direct sunlight.
- **Dust.** Dust on the signal transmitter or receiver will reduce sensitivity. Wipe off dust with a soft cloth.
- **Fluorescent lights.** Signal communication might be disabled if fluorescent lamps are in the room. In that case, contact your installer.
- **Other appliances.** If the user interface signals operate other appliances, move the other appliances, or contact your installer.
- **Curtains.** Make sure that the signal between the unit and the user interface is NOT blocked by curtains or other objects.



### NOTICE

- Do NOT drop the user interface.
- Do NOT let the user interface get wet.

## 3.2.1 Components: User interface

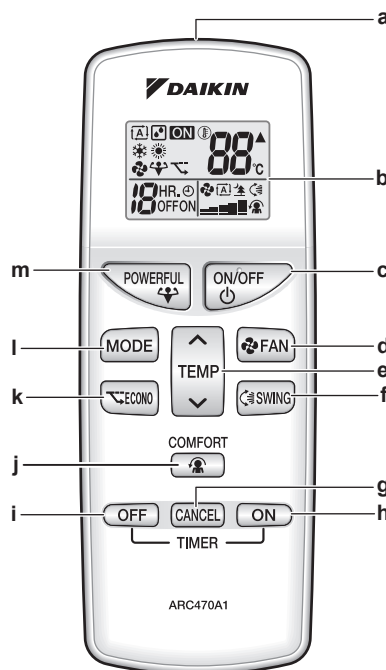

- a Signal transmitter
- b LCD display
- c ON/OFF button
- d Fan setting button
- e Temperature adjustment button
- f Swing button
- g Timer cancel button
- h ON timer button
- i OFF timer button
- j Comfort airflow button
- k Econo button
- l Mode selector button
- m Powerful button

## 3.2.2 Status: User interface LCD

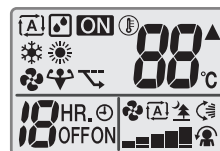

Icon	Description
	Operation mode = Automatic
	Operation mode = Drying
	Operation mode = Heating
	Operation mode = Cooling
	Operation mode = Fan only
	Powerful operation is active
	Econo operation is active
<b>ON</b>	Operation is active
	The indoor unit receives a signal from the user interface
	Current temperature setting
	Airflow rate = Automatic
	Airflow rate = Indoor unit quiet

## 4 Before operation

Icon	Description
	Airflow rate = High
	Airflow rate = Medium high
	Airflow rate = Medium
	Airflow rate = Medium low
	Airflow rate = Low
	Comfort operation is active
	Auto vertical swing is active
	ON timer is active
	OFF timer is active

### 3.2.3 To operate the user interface

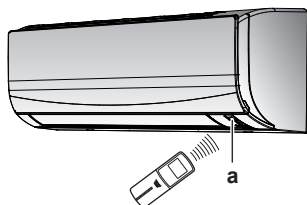

a Signal receiver

- 1 Aim the signal transmitter at the signal receiver on the indoor unit (maximum distance for communication is 7 m).

**Result:** When the indoor unit receives a signal from the user interface, you will hear a sound:

Sound	Description
Beep-beep	Operation starts.
Beep	Setting changes.
Long beep	Operation stops.

## 4 Before operation

### 4.1 To mount the user interface holder

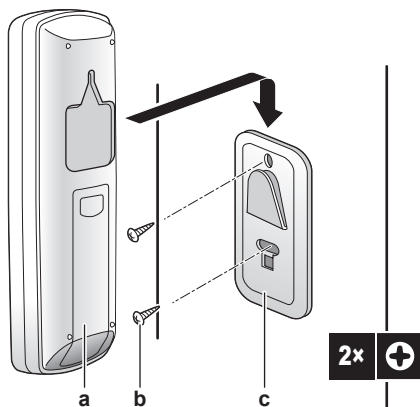

a User interface  
b Screws (field supply)  
c User interface holder

- 1 Choose a place where the signals reach the unit.
- 2 Attach the holder with screws to the wall or a similar location.

- 3 Hang the user interface on the user interface holder.

### 4.2 To insert the batteries

The batteries will last for about 1 year.

- 1 Remove the back cover.
- 2 Insert both batteries at once.
- 3 Put the cover back.

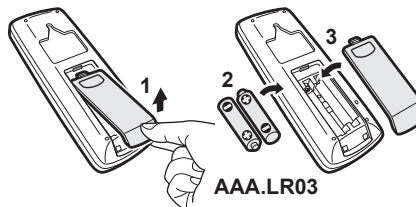

### 4.3 To turn on the power supply

- 1 Turn the circuit breaker on.

**Result:** The flap of the indoor unit will open and close to set the reference position.

## 5 Operation

### 5.1 Operation range

Use the system in the following temperature and humidity ranges for safe and effective operation.

Operation mode	Operation range
Cooling <sup>(a)(b)</sup>	<ul style="list-style-type: none"> <li>Outdoor temperature: -10~46°C DB</li> <li>Indoor temperature: 18~32°C DB</li> <li>Indoor humidity: ≤80%</li> </ul>
Heating <sup>(a)</sup>	<ul style="list-style-type: none"> <li>Outdoor temperature: -15~24°C DB</li> <li>Indoor temperature: 10~30°C DB</li> </ul>
Drying <sup>(a)</sup>	<ul style="list-style-type: none"> <li>Outdoor temperature: -10~46°C DB</li> <li>Indoor temperature: 18~32°C DB</li> <li>Indoor humidity: ≤80%</li> </ul>

<sup>(a)</sup> A safety device might stop the operation of the system if the unit runs outside its operation range.

<sup>(b)</sup> Condensation and water dripping might occur if the unit runs outside its operation range.

### 5.2 When to use which feature

You can use the following table to determine which features to use:

Feature	Tasks
<b>Basic features</b>	
Operation modes and temperature	<p>To start/stop the system and to set the temperature:</p> <ul style="list-style-type: none"> <li>Heat up or cool down a room.</li> <li>Blow air in a room without heating or cooling.</li> <li>Decrease the humidity in a room.</li> <li>In Automatic mode, automatically select an appropriate temperature and operation mode.</li> </ul>
Airflow direction	To adjust the airflow direction (swing or fixed position).



Feature	Tasks
Airflow rate	To adjust the amount of air blown into the room. To run more quietly.
<b>Advanced features</b>	
Econo	To use the system when you are also using other power-consuming appliances. To save energy.
Comfort	To provide a comfortable airflow that does NOT come in direct contact with people.
Powerful	To cool down or heat up the room quickly.
ON timer +  OFF timer	To automatically turn ON or OFF the system.

### 5.3 Operation mode and temperature setpoint

**When.** Adjust the system operation mode and set the temperature when you want to:

- Heat up or cool down a room
- Blow air in a room without heating or cooling
- Decrease the humidity in a room

**What.** The system operates differently, depending on the user selection.

Setting	Description
Automatic	The system cools down or heats up a room to the temperature setpoint. It automatically switches between cooling and heating if necessary.
Drying	The system decreases the humidity in a room.
Heating	The system heats up a room to the temperature setpoint.
Cooling	The system cools down a room to the temperature setpoint.
Fan	The system only controls the airflow (airflow rate and airflow direction). The system does NOT control the temperature.

#### Additional info:

- **Outside temperature.** The system's cooling or heating effect decreases when the outside temperature is too high or too low.
- **Defrost operation.** During heating operation, frost might occur on the outdoor unit and decrease the heating capacity. In that case, the system automatically switches to defrosting operation to remove the frost. During defrosting operation, hot air is NOT blown from the indoor unit.

#### 5.3.1 To start/stop operation mode and to set the temperature

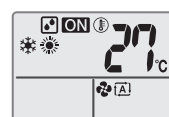

**ON**: Unit is operating.

: Operation mode = Automatic

: Operation mode = Drying

: Operation mode = Heating

: Operation mode = Cooling

: Operation mode = Fan only



**88°C**: Shows the set temperature.

- 1 Press one or more times to select the operation mode.

**Result:** The mode will be set in the following sequence:



- 2 Press to **start** operation.

**Result:** **ON** is displayed on the LCD.

**Result:** The operation lamp lights up.



- 3 Press or on the button one or more times to lower or raise the **temperature**.

**Note:** When using drying or fan only mode, you cannot adjust the temperature.

- 4 Press to **stop** operation.

**Result:** **ON** disappears from the LCD.

**Result:** The operation lamp goes off.

#### 5.3.2 Airflow rate

- 1 Press to choose:

	5 airflow rate levels, from "==" to "=="
	Automatic airflow rate operation
	Indoor unit quiet operation. When the airflow rate is set to "≡", the noise from the unit will be reduced.



#### INFORMATION

- If the unit reaches the temperature setpoint in cooling or heating mode, the fan will stop operating.
- When using drying operation mode, you CANNOT adjust the airflow rate setting.

#### To adjust the airflow rate

- 1 Press to change the airflow setting as follows:



## 5 Operation

### 5.3.3 Airflow direction

**When.** Adjust the airflow direction as desired.

**What.** The system directs the airflow differently, depending on the user selection (swinging or fixed position). It does so by moving the vertical blades.

Setting	Airflow direction
Vertical auto swing	Moves up and down.
[—]	Stays in a fixed position.



#### CAUTION

- ALWAYS use a user interface to adjust the angle of the flap. When the flap is swinging and you move it forcibly by hand, the mechanism will break.
- Be careful when adjusting the louvers. Inside the air outlet, a fan is rotating at high speed.

**Note:** The movable range of the flap varies according to the operation mode. The flap will stop at the upper position when the airflow rate is changed to low during the up and down swing setting.

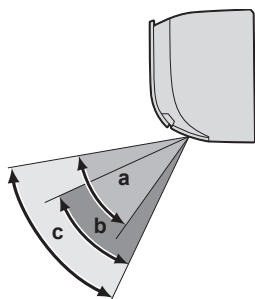

- a Flap range in cooling or drying operation
- b Flap range in heating operation
- c Flap range in fan only operation

#### To adjust the airflow direction

- To use auto swing, press .

**Result:** will appear on the LCD.

**Result:** The flap (horizontal blade) will begin to swing.

- To use fixed position, press when the flap reaches the desired position.

**Result:** disappears from the LCD.

#### To adjust the louvers (vertical blades)

- Hold 1 or both knobs and move the louvers.

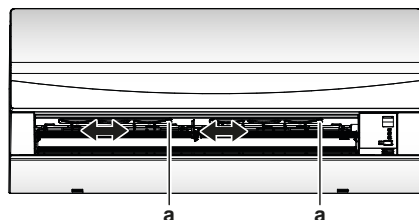

a Knobs



#### INFORMATION

When the unit is installed in a corner of a room, the direction of the louvers should be facing away from the wall. Efficiency will drop if a wall blocks the air.

### 5.3.4 Comfort airflow operation

This operation can be used in **heating** or **cooling** operation mode. It will provide a comfortable wind that will NOT come in direct contact with people. The system automatically sets the fixed airflow position upward in Cooling and downward in Heating operation mode.

#### Cooling operation mode

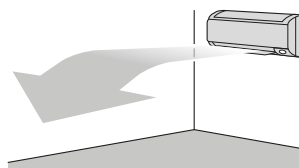

#### Heating operation mode

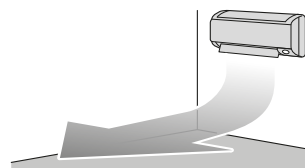

#### INFORMATION

Powerful and Comfort airflow operation CANNOT be used at the same time. The last selected function takes priority. If the vertical automatic swing is selected, Comfort airflow operation will be cancelled.

#### To start/stop Comfort airflow operation

- Press to start.

**Result:** The flap position will change, is displayed on the LCD, and the airflow rate is set to automatic.

Mode	Position of flap...
Cooling/Drying	Up
Heating	Down

- Press to stop.

**Result:** The flap will return to the position from before the Comfort airflow mode; disappears from the LCD.

### 5.3.5 Powerful operation

This operation quickly maximizes the cooling/heating effect in any operation mode. You can get the maximum capacity.



#### INFORMATION

Powerful operation CANNOT be used together with Econo and Comfort airflow operation. The last selected function takes priority.

Powerful operation will NOT increase the capacity of the unit if it already operates at maximum capacity.

#### To start/stop Powerful operation

- Press to start.

**Result:** is displayed on the LCD. Powerful operation runs for 20 minutes; after that, operation returns to the previously set mode.

- Press to stop.

**Result:** disappears from the LCD.

**Note:** Powerful operation can be set only when the unit is running. If

you press or if you change operation mode, operation will be cancelled; disappears from the LCD.



### 5.3.6 Econo operation

This is a function which enables efficient operation by limiting the maximum power consumption value. This function is useful for cases in which attention should be paid to ensure a circuit breaker will not trip when the product runs alongside other appliances.



#### INFORMATION

- Powerful and Econo operation CANNOT be used at the same time. The last selected function takes priority.
- Econo operation reduces power consumption of the outdoor unit by limiting the rotation speed of the compressor. If power consumption is already low, Econo operation will NOT further reduce power consumption.

#### To start/stop Econo operation

- Press to start.

**Result:** is displayed on the LCD.

- Press to stop.

**Result:** disappears from the LCD.

### 5.3.7 OFF/ON timer operation

Timer functions are useful for automatically switching the air conditioner off/on at night or in the morning. You can also use OFF timer and ON timer in combination.



#### INFORMATION

Program the timer again in case of:

- A breaker has turned the unit off.
- A power failure.
- After replacing batteries in the user interface.

#### To start/stop ON timer operation

- Press to start.

**Result:** ON is displayed on the LCD and the timer lamp lights up.



#### INFORMATION

Each time is pressed, the time setting advances by 1 hour. The timer can be set between 1 to 12 hours.

- Press to stop.

**Result:** ON disappears from the LCD and the timer lamp goes off.

#### To start/stop OFF timer operation

- Press to start.

**Result:** OFF is displayed on the LCD and the timer lamp lights up.



#### INFORMATION

Each time is pressed, the time setting advances by 1 hour. The timer can be set between 1 to 9 hours.

- Press to stop.

**Result:** OFF disappears from the LCD and the timer lamp goes off.



#### INFORMATION

When you set the ON/OFF timer, the time setting is stored in the memory. The memory will be reset when the user interface batteries are replaced.

#### Use of night set mode in combination with OFF timer

The air conditioner automatically adjusts the temperature setting (0.5°C up in cooling, 2.0°C down in heating) to prevent excessive cooling/heating and ensure a comfortable sleeping temperature.

#### To combine OFF timer and ON timer

- To set the timers, refer to "To start/stop OFF timer operation" [p. 9] and "To start/stop ON timer operation" [p. 9].

**Result:** OFF and ON are displayed on the LCD.

- Example of what is displayed on the LCD if you combine the 2



timers:

## 6 Energy saving and optimum operation



#### INFORMATION

- Even if the unit is turned OFF, it consumes electricity.
- When the power turns back on after a power break, the previously selected mode will be resumed.



#### CAUTION

NEVER expose little children, plants or animals directly to the airflow.



#### WARNING

Do NOT place objects below the indoor and/or outdoor unit that may get wet. Otherwise condensation on the unit or refrigerant pipes, air filter dirt or drain blockage may cause dripping, and objects under the unit may get dirty or damaged.



#### WARNING

Do NOT place a flammable spray bottle near the air conditioner and do NOT use sprays near the unit. Doing so may result in a fire.



#### CAUTION

Do NOT operate the system when using a room fumigation-type insecticide. Chemicals could collect in the unit, and endanger the health of people who are hypersensitive to chemicals.

Observe the following precautions to ensure the system operates properly.

- Prevent direct sunlight from entering a room during cooling operation by using curtains or blinds.
- Make sure the area is well ventilated. Do NOT block any ventilation openings.
- Ventilate often. Extended use requires special attention to ventilation.
- Keep doors and windows closed. If the doors and windows remain open, air will flow out of your room causing a decrease in the cooling or heating effect.
- Be careful NOT to cool or heat too much. To save energy, keep the temperature setting at a moderate level.

## 7 Maintenance and service

- NEVER place objects near the air inlet or the air outlet of the unit. Doing so may cause a reduced heating/cooling effect or stop operation.
- Turn the breaker off when the unit is NOT used for longer periods of time. If the breaker is on, the unit consumes electricity. Before restarting the unit, turn the breaker on 6 hours before operation to ensure smooth running.
- Condensation may form if the humidity is above 80% or if the drain outlet gets blocked.
- Adjust the room temperature properly for a comfortable environment. Avoid excessive heating or cooling. Notice that it may take some time for the room temperature to reach the set temperature. Consider using the timer setting options.
- Adjust the air flow direction to avoid cool air from gathering on the floor or warm air against the ceiling. (Up during cooling or dry operation to the ceiling and down during heating operation.)
- Avoid direct air flow to room inhabitants.
- Operate the system within the recommended temperature range (26~28°C for cooling and 20~24°C for heating) to save energy.

## 7 Maintenance and service

### 7.1 Overview: Maintenance and service

The installer has to perform a yearly maintenance.

#### About the refrigerant

This product contains fluorinated greenhouse gases. Do NOT vent gases into the atmosphere.

Refrigerant type: R32

Global warming potential (GWP) value: 675

#### NOTICE

Applicable legislation on **fluorinated greenhouse gases** requires that the refrigerant charge of the unit is indicated both in weight and CO<sub>2</sub> equivalent.

**Formula to calculate the quantity in CO<sub>2</sub> equivalent tonnes:** GWP value of the refrigerant × total refrigerant charge [in kg] / 1000

Please contact your installer for more information.

#### WARNING

The refrigerant inside the unit is mildly flammable, but normally does NOT leak. If the refrigerant leaks in the room and comes in contact with fire from a burner, a heater, or a cooker, this may result in fire, or the formation of a harmful gas.

Turn off any combustible heating devices, ventilate the room, and contact the dealer where you purchased the unit.

Do NOT use the unit until a service person confirms that the part from which the refrigerant leaked has been repaired.

#### WARNING

- Do NOT pierce or burn refrigerant cycle parts.
- Do NOT use cleaning materials or means to accelerate the defrosting process other than those recommended by the manufacturer.
- Be aware that the refrigerant inside the system is odourless.

#### NOTICE

Maintenance MUST be done by an authorized installer or service agent.

We recommend performing maintenance at least once a year. However, applicable legislation might require shorter maintenance intervals.

#### DANGER: RISK OF ELECTROCUTION

To clean the air conditioner or air filter, be sure to stop operation and turn all power supplies off. Otherwise, an electric shock and injury may result.

#### WARNING

To prevent electrical shocks or fire:

- Do NOT rinse the unit.
- Do NOT operate the unit with wet hands.
- Do NOT place any objects containing water on the unit.

#### CAUTION

After a long use, check the unit stand and fitting for damage. If damaged, the unit may fall and result in injury.

#### CAUTION

Do NOT touch the heat exchanger fins. These fins are sharp and could result in cutting injuries.

#### WARNING

Be careful with ladders when working in high places.

#### NOTICE

Maintenance MUST be done by an authorized installer or service agent.

Use Daikin service parts only.

We recommend performing maintenance at least once a year. However, applicable legislation might require shorter maintenance intervals.

### 7.2 To clean the indoor unit and user interface

#### NOTICE

- Do NOT use gasoline, benzene, thinner, polishing powder or liquid insecticide. **Possible consequence:** Discoloration and deformation.
- Do NOT use water or air of 40°C or higher. **Possible consequence:** Discoloration and deformation.
- Do NOT use polishing compounds.
- Do NOT use a scrubbing brush. **Possible consequence:** The surface finishing peels off.
- As an end user, you may NEVER clean inside parts of the unit by yourself; this work must be performed by a qualified service person. Contact your dealer.

#### DANGER: RISK OF ELECTROCUTION

Before cleaning, be sure to stop the operation, turn the breaker off or pull out the supply cord. Otherwise, an electric shock and injury may result.

- 1 Clean with a soft cloth. If it is difficult to remove stains, use water or a neutral detergent.

### 7.3 To clean the front panel

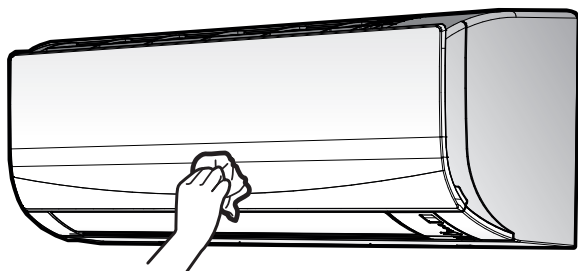

- 1 Clean the front panel with a soft cloth. If it is difficult to remove stains, use water or a neutral detergent.

### 7.4 About the air filters

Operating the unit with dirty filters means that the filter:

- CANNOT deodorise the air,
- CANNOT clean the air,
- poor heating/cooling,
- causes odour.

### 7.5 To clean the air filters

- 1 Push the tab at the centre of each air filter, then pull it down.
- 2 Pull out the air filters.

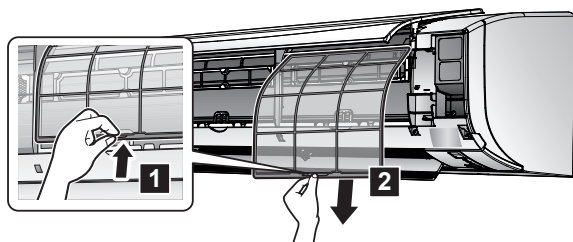

- 3 Wash the air filters with water or clean them with a vacuum cleaner.

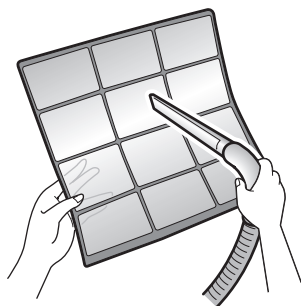

- 4 Soak in lukewarm water for about 10 to 15 minutes.



- 5 Install all filters back in their original positions.

#### **i** INFORMATION

- If the dust does NOT come off easily, wash them with a neutral detergent diluted in lukewarm water. Dry the air filters in the shade.
- It is recommended to clean the air filters every 2 weeks.

For FTXF20+25C5V1B and ATXF20-25C5V1B

#### **i** INFORMATION

During cooling operation, water droplets might occur on the shield plate; this does NOT have affect operation.

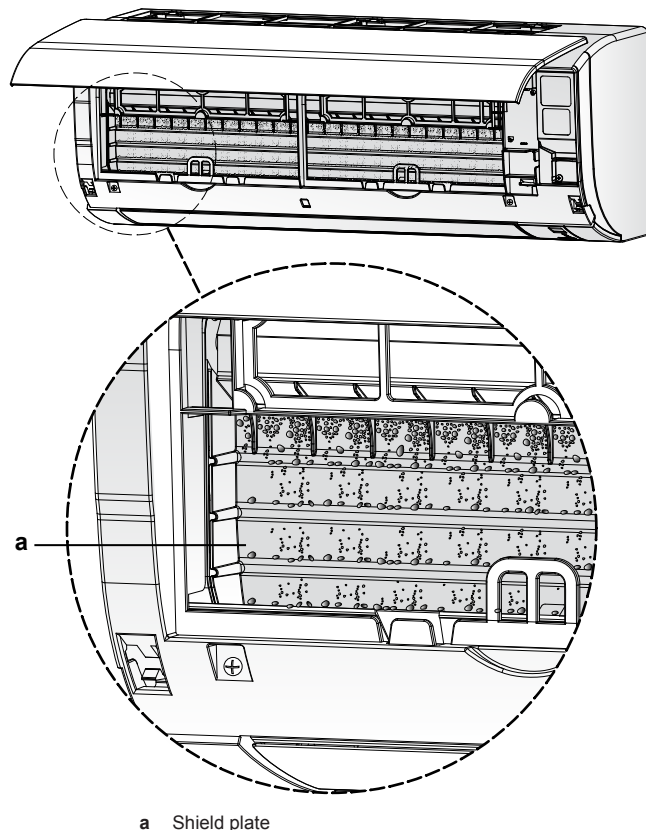

### 7.6 To take following items into account before a long idle period

Operate the unit in **fan only** mode for several hours to dry the inside of the unit.

- 1 Press **MODE** and select fan only operation.
- 2 Press **ON/OFF** to start operation.
- 3 After operation stops, turn the breaker off.
- 4 Clean the air filters and replace them in their original position.
- 5 Remove the batteries from the user interface.

#### **i** INFORMATION

It is recommended to have periodical maintenance performed by a specialist. For specialist maintenance, contact your dealer. Maintenance costs shall be borne by the customer.

In certain operating conditions the inside of the unit may get dirty after several seasons of use. This results in poor performance.

## 8 Troubleshooting

### 8 Troubleshooting

If one of the following malfunctions occur, take the measures shown below and contact your dealer.



#### WARNING

**Stop operation and shut off the power if anything unusual occurs (burning smells etc.).**

Leaving the unit running under such circumstances may cause breakage, electric shock or fire. Contact your dealer.

The system **MUST** be repaired by a qualified service person.

Malfunction	Measure
If a safety device such as a fuse, a breaker or an earth leakage breaker frequently actuates or the ON/OFF switch does NOT properly work.	Turn OFF the main power switch.
If water leaks from the unit.	Stop the operation.
The operation switch does NOT work well.	Turn OFF the power supply.
If the user interface display indicates the unit number, the operation lamp flashes and the malfunction code appears.	Notify your installer and report the malfunction code.

If the system does NOT operate properly except for the above mentioned cases and none of the above mentioned malfunctions is evident, investigate the system in accordance with the following procedures.



#### INFORMATION

Refer to the reference guide located on <http://www.daikineurope.com/support-and-manuals/product-information/> for more troubleshooting tips.

If after checking all above items, it is impossible to fix the problem yourself, contact your installer and state the symptoms, the complete model name of the unit (with manufacturing number if possible) and the installation date (possibly listed on the warranty card).

### 8.1 Symptoms that are NOT system malfunctions

The following symptoms are NOT system malfunctions:

#### 8.1.1 Symptom: A sound like water flowing is heard

- This sound is caused by the refrigerant flowing in the unit.
- This sound may be generated when water is flowing away from the unit during cooling or drying operation.

#### 8.1.2 Symptom: A blowing sound is heard

This sound is generated when the direction of the refrigerant flow is changed (e.g. when switching from cooling to heating).

#### 8.1.3 Symptom: A ticking sound is heard

This sound is generated when the unit slightly expands or contracts with changes in temperature.

#### 8.1.4 Symptom: A whistling sound is heard

This sound is generated by the refrigerant flowing during defrost operation.

#### 8.1.5 Symptom: A clicking sound during operation or idle time is heard

This sound is generated when the refrigerant control valves or electrical parts operate.

#### 8.1.6 Symptom: A clapping sound is heard

This sound is generated when an external device sucks air out of the room (e.g. exhaust fan, extractor hood) while the doors and windows in the room are closed. Open the doors or windows, or turn off the device.

#### 8.1.7 Symptom: The outdoor fan rotates while the air conditioner is not in operation

- After operation has stopped.** The outdoor fan continues to rotate for another 30 seconds for system protection.
- While the air conditioner is not in operation.** When the outdoor temperature is very high, the outdoor fan starts to rotate for system protection.

## 8.2 Solving problems based on error codes

### Fault diagnosis by user interface

If the unit runs into a problem, you can identify the fault by checking the error code by the user interface. It is important to understand the problem and take measures before resetting the error code. This should be done by a licensed installer or your local dealer.



#### INFORMATION

See the service manual for:

- The complete list of error codes
- A more detailed troubleshooting guideline for each error

### To check the error code by the user interface

- Aim the user interface at the unit and press **CANCEL** for about 5 seconds.

**Result:** **00** blinks in the temperature setting display section.

- Aim the user interface at the unit and press **CANCEL** repeatedly until a continuous beep is heard.

**Result:** The code is now displayed on the display.



#### INFORMATION

- A short beep and 2 consecutive beeps indicate non-corresponding codes.
- To cancel the code display, hold **CANCEL** for 5 seconds. The code will also disappear from the display if the button is NOT pressed within 1 minute.

### System

Error code	Description
00	Normal
U0	Refrigerant shortage
U2	Overvoltage detection
U4	Signal transmission error (between indoor and outdoor unit)
UR	Indoor/outdoor unit combination fault

### Indoor unit

Error code	Description
R1	Indoor unit PCB abnormality

Error code	Description
R5	Freeze-up protection or high-pressure control
R6	Fan motor (DC motor) abnormality
L9	Room temperature thermistor abnormality

**Outdoor unit**

Error code	Description
E8	4-way valve abnormality
E1	Outdoor unit PCB abnormality
E5	Overload activation (compressor overload)
E6	Compressor lock
E7	DC fan lock
E8	Input power overcurrent
F3	Discharge pipe temperature control
F6	High-pressure control (in cooling mode)
H0	Compressor system sensor abnormality
H6	Position sensor abnormality
H8	DC voltage / current sensor abnormality
H9	Outdoor temperature thermistor abnormality
J3	Discharge pipe thermistor abnormality
J6	Outdoor heat exchanger thermistor abnormality
L3	Electrical parts heat error
L4	Radiation fin temperature rise
L5	Inverter instantaneous overcurrent (DC)
P4	Radiation fin thermistor abnormality
F8	Compressor internal temperature error

## 9 Disposal

**NOTICE**

Do NOT try to dismantle the system yourself: dismantling of the system, treatment of the refrigerant, oil and other parts MUST comply with applicable legislation. Units MUST be treated at a specialised treatment facility for reuse, recycling and recovery.







**DAIKIN ISITMA VE SOĞUTMA SİSTEMLERİ SAN.TİC. A.Ş.**

Gülsuyu Mahallesi, Fevzi Çakmak Caddesi, Burçak Sokak, No:20, 34848 Maltepe

İSTANBUL / TÜRKİYE

Tel: 0216 453 27 00

Faks: 0216 671 06 00

Çağrı Merkezi: 444 999 0

Web: [www.daikin.com.tr](http://www.daikin.com.tr)

Copyright 2020 Daikin

**DAIKIN EUROPE N.V.**

Zandvoordestraat 300, B-8400 Oostende, Belgium

3P520336-9K 2020.08